



Shelley Crescent Hounslow

£974,950

Freehold

Nestled in the desirable area of Shelley Crescent, Hounslow, this stunning semi detached house offers an impressive living space of 2,314 square feet. With five well proportioned bedrooms and four modern bathrooms, this property is perfect for families seeking both comfort and style.

Upon entering, you are greeted by two spacious reception rooms that provide ample space for relaxation and entertaining. The heart of the home is undoubtedly the open plan kitchen and living area, which creates a warm and inviting atmosphere, ideal for family gatherings and social occasions. The kitchen is designed with contemporary finishes, ensuring both functionality and elegance.

Each of the bedrooms is generously sized, with several featuring en suite bathrooms, providing convenience and privacy for family members and guests alike. The property has been extended and is presented in immaculate condition throughout, making it ready for you to move in without the need for any immediate renovations.

For those with vehicles, the property boasts parking for multiple cars, a valuable feature in this bustling area. The combination of space, modern amenities, and a prime location makes this house a rare find in Heston. Do not miss the chance to make this exceptional house your new home.



Shelley Crescent, Heston

Approximate Gross Internal Area
2314 sq ft - 215 sq m

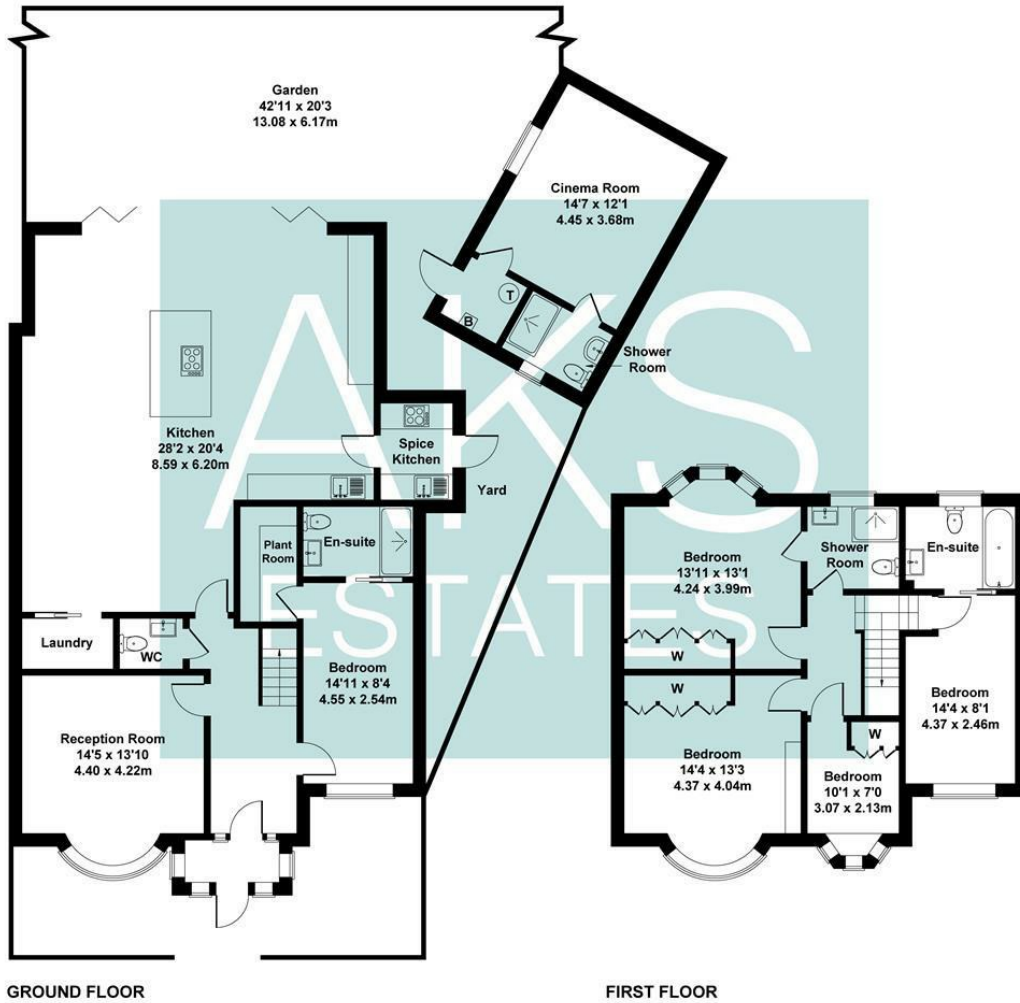

Not to Scale. Produced by The Plan Portal 2025
For Illustrative Purposes Only.

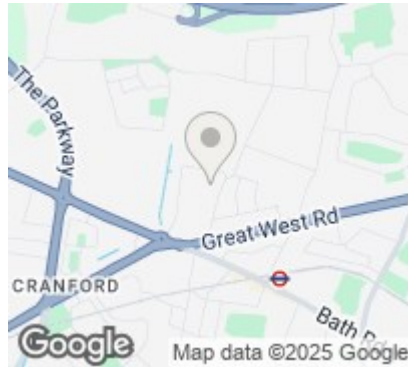

Energy Efficiency Rating		
	Current	Potential
Very energy efficient - lower running costs		
(92 plus) A		
(81-91) B		
(69-80) C		
(55-68) D		
(39-54) E		
(21-38) F		
(1-20) G		
Not energy efficient - higher running costs		
England & Wales		
EU Directive 2002/91/EC		

Agents Note: Whilst every care has been taken to prepare these particulars, they are for guidance purposes only. All measurements are approximate and are for general guidance purposes only and whilst every care has been taken to ensure their accuracy, they should not be relied upon and potential buyers/tenants are advised to recheck the measurements

Heston
131A Heston Road
Hounslow
TW5 0RF

020 8059 0595
shiv@aksestates.co.uk
aksestates.co.uk

